

SNOWFLAKE SUNCATCHER



Crafts-to-Go

for Adults



Get ready for some ooey-gooey fun with glue and a little string. Patience and creativity come together to make this cute suncatcher, perfect for brightening any room this winter! See our Instagram page to follow along.

MATERIALS INCLUDED

- Pattern
- Ink
- Toothpick
- String
- Suction Cup
- Plastic Lacing
- Glue
- Paintbrush

MATERIALS YOU'LL NEED

- Parchment Paper
- Scissors
- Tape
- Ruler
- Paper Cup or Lid

INSTRUCTIONS

1. Cut white string as follows: 1 piece - 1.25" ; 6 pieces - 1.5" ; 6 pieces - 4.5"
2. Tape the snowflake pattern to your workspace, then tape wax or parchment paper over the pattern. Make it as smooth and unwrinkled as possible.

****Have a damp cloth on hand to wipe your fingers****

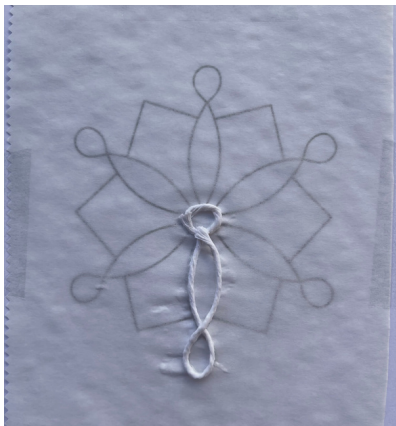

3. Squeeze plenty of glue into a paper cup or disposable lid and submerge the smallest string into the glue. Remove the excess with your fingers. Lay this string around the center circle and make sure the ends are touching.
4. Take one of the 4.5" strings and submerge it in the glue, then squeeze off the excess. Lay it over one of the figure 8 sections, making sure the two ends meet at the center of the circle.
5. Repeat step 4 with the other 5 pieces of 4.5" string.

Note: Make sure all strings touch the connecting strings so the glue will dry them all together

SNOWFLAKE SUNCATCHER

Pro Tip: Use a toothpick to manipulate the strings exactly where you want them!

6. Take the 1.5" strings and repeat the process, this time laying them atop the remaining lines on the pattern

7. Carefully slip the plastic lacing through one of the small loops. This will later attach to the suction hanger.

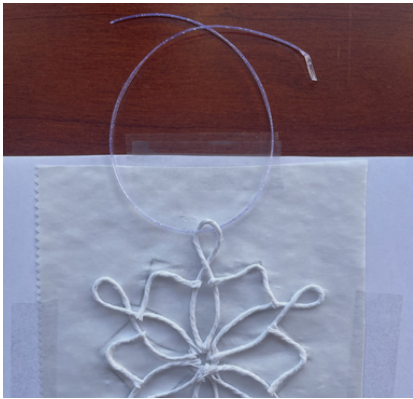

Keep the lacing as flat as possible to avoid making the loop lift too far off the parchment paper.

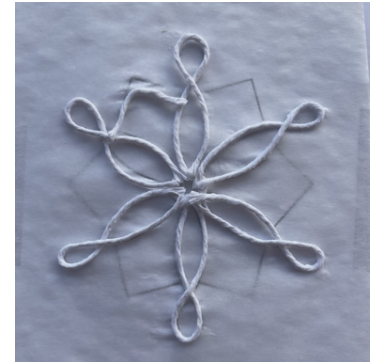

Note: don't worry if your strings don't line up perfectly on the pattern. Remember, every snowflake is different, and that's what makes them fun!

8. Dot each connecting joint with a spot of glue, then let the snowflake completely dry. This could take up to 12 hours.

9. Once the snowflake is completely dry, decide which spaces you want to fill in with glue and watercolor ink. (Hint: be strategic, as the spaces you choose not to fill add to the overall effect too! Also, a little ink goes a LONG way.)

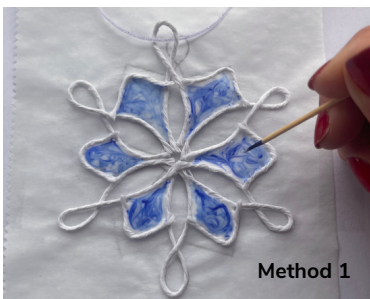
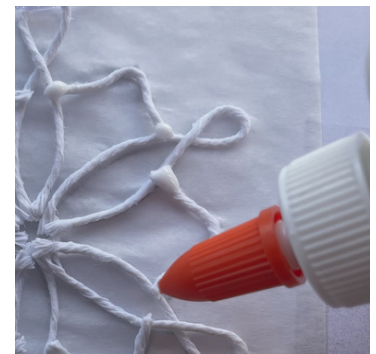

Use one or both methods below to create your snowflake:

Method 1: For a marbled look, first fill the space to the top with glue. Then dip the toothpick into the ink and swirl into the glue.

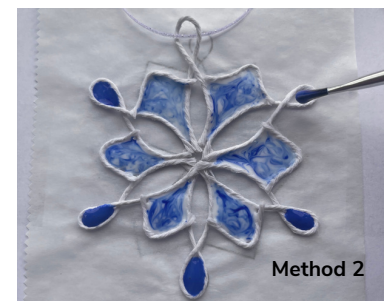

Method 2: For an even tone, mix glue and a dot of ink in a container outside the snowflake, then fill in the desired spaces.

10. Allow snowflake to dry for 24 hours before gently peeling off the parchment paper. Then, knot and secure the plastic lacing to the suction cup to hang. ENJOY!